

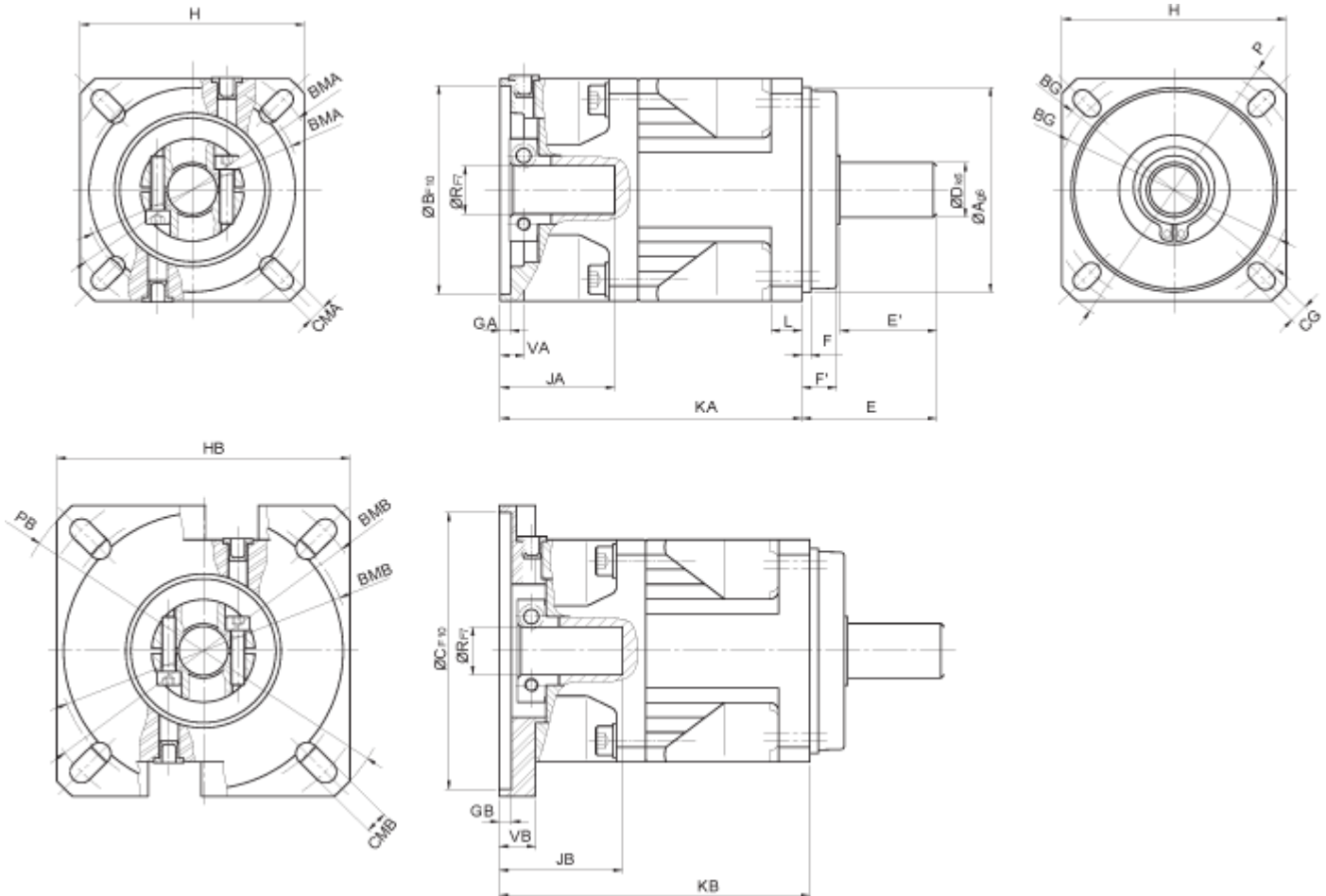

## Magmotor Performance Gearbox

### MP Dimensions



Size			MP-010	MP-020	MP-030	MP-040	MP-050
Square Flange	H		65	85	115	142	190
Pilot $\emptyset$	A	h6	60	70	100	130	160
Output Shaft $\emptyset$	D	k6	16	22	32	40	55
Mounting Bolt Circle	BG		68-75	85-100	115-130	165	215
Mounting Holes	CG	4x90°	5.5	6.6	8.5	11	13
Flange Thickness	L		9	11	13	18	22
Outside $\emptyset$	P		86	113	152	187	246
Length: Mount flange to end of shaft	E		39	49	85	112	112
Usable shaft length	E'		28	36	58	82	82
Pilot length	F		2.5	3	4	8	10
Shoulder length	F'		10	12	25	27	27
Body length with A flange	KA		87.5	118.5	156.5	136.5	182
			-	-	-	187.5	242
Body length with B flange	KB		90	128.8	157.5	136.5	-
			-	-	-	187.5	-

			A	B	A	B	A	B	A	B	A	B
<b>Motor Interface Dimensions</b>												
<b>Maximum Motor Pilot Ø</b>	<b>C</b>		61	81	81	101	111	131	131	181	181	
<b>Maximum Pilot Length</b>	<b>G</b>		3	3.5	3.5	4	4	4	5	5.5	6	
<b>Square Flange</b>	<b>H</b>		65	85	85	115	115	142	142	190	190	
<b>Bolt Circle for Motor</b>	<b>BM</b>		63-75	85-100	85-100	115-130	115-130	145-165	145-165	200-215	200-215	
<b>Mounting Holes</b>	<b>CM</b>		5.5	6.5	6.6	8.5	8.5	11	11	13	13	
<b>Flange Thickness</b>	<b>V</b>		7	10.5	10	16	12	15	15	18	20	
<b>Flange Ø</b>	<b>P</b>		86	114	113	149	152	188	187	246	246	
<b>Maximum Motor Shaft Length</b>	<b>J</b>		32	35	40	50	50	53	60	60	80	
<b>Maximum Motor Shaft Ø</b>	<b>R</b>	F7		14		19		24		32	38	

## Performance Ratings

Size			Ratio	MP-010		MP-020		MP-030		MP-040		MP-050	
				TN	TP	TN	TP	TN	TP	TN	TP	TN	TP
<b>Continuous Output Torque</b>	Nm	1 stage	4	30	60	96	192	192	384	360	720	720	1440
			5	27	54	90	180	200	400	360	720	750	1500
7	32		64	70	140	175	350	360	720	750	1500		
<b>Peak Output Torque</b>	TP		9	20	40	72	144	117	234	-	-	-	-
			10	-	-	-	-	-	-	300	600	650	1300
2 stage	16		31	62	96	192	192	384	360	720	720	1440	
	20		27	54	100	200	200	400	360	720	750	1500	
	28		32	64	70	140	175	350	360	720	750	1500	
	36		19	38	67	135	117	234	-	-	-	-	
	40		30	60	96	192	192	384	360	720	720	1440	
	50		27	54	100	200	200	400	360	360	750	1500	
	70		31	62	70	140	175	350	360	360	750	1500	
	90		19	38	67	135	117	234	-	-	-	-	
	100		-	-	-	-	-	-	300	600	650	1300	
	<b>Backlash</b>	arcmin	1 stage	Reduced ≤ 3 - Standard ≤ 6									
2 stage			Reduced ≤ 5 - Standard ≤ 8										
<b>Continuous Input Speed</b>	RPM		3000		3000		3000		2500		2500		
<b>Maximum Input Speed</b>	RPM		6000		6000		6000		4000		4000		
<b>Maximum Radial Load</b>	N		1100		1500		4400		6900		11000		
<b>Maximum Axial Load</b>	N		550		750		2200		3450		5500		
<b>Efficiency</b>	h %	1 stage	96										
		2 stage	94										
<b>Input Inertia</b>	kgcm <sup>2</sup>	1 stage	i										
			4	0.1058		0.491		2.8631		8.229		Consult Facotry	
			5	0.0937		0.447		2.679		7.2196			
			7	0.084		0.4153		2.542		6.3714			
			9	0.0799		0.4021		2.4829		-			
			10	-		-		-		5.9346			
			2 stage	16	0.0886		0.4377		2.5743		7.1797		
		20	0.088		0.435		2.5627		7.1166				
		28	0.0873		0.433		2.5542		7.0636				
		36	0.087		0.4322		2.5505		-				
		40	0.0721		0.3585		2.367		5.7486				
		50	0.072		0.358		2.3651		5.7385				
		70	0.0719		0.3577		2.3638		5.73				
		90	0.0718		0.3576		2.3632		-				
100	-		-		-		5.7256						
<b>Weight with interface A / B</b>	kg	1 stage		1.1	1.2	2.9	3.25	6.9	7.3				
		2 stage		1.3	1.4	3.4	3.75	7.7	8.1				
<b>Temperature range</b>	°C		-10°C to 90°C										
<b>Noise (measured @ 3000 rpm)</b>	dB(A)		≤ 69										
<b>Life</b>	h		>15,000										
<b>Lubrication</b>			Grease					Oil					
<b>Orientation</b>			Any										